

## 1-1/2" WB METALLIC Models MODEL: WB15X-XXX-XXX

### SPECIFICATIONS:

Ratio:	1:1
Maximum GPM (LPM):	123 (466)
Displacement per cycle Gallons (Liters):	0.617 (2.34)
Air Inlet (Female):	1/2 - 14 N.P.T.
Fluid Inlet/Outlet:	1-1/2" - 11-1/2 N.P.T.F.-1, Rp1-1/2(1-1/2-11BSP) 1-1/2" ANSI/DIN hybrid flange
Max. operating pressure psi (bar):	120 (8.3)
Suspended solids max. dia. in.(mm):	1/4" (6.4)
Weight lbs (kg):	WB15R-XAX-XXX 37.7 (17.1) WB15R-XCX-XXX 73.2 (33.2) WB15R-XSX-XXX 61.2 (27.8) WB15R-XHX-XXX 86.9 (39.4)
	Note: add 2.14 lbs (0.97 kg) for aluminum air motor section add 18.14 lbs (8.23 kg) for stainless steel air motor section
Maximum dry suction lift ft(m):	14 (4.2)
Sound Level:	70 PSI 50 Cycles/Min 81.0 db(A)
Muffler Included:	350-568



### MODEL DESCRIPTION & ORDERING:

Position	1	2		3	4	5		6	7	8				
Example:	WB15	X	-	X	X	X	-	X	X	X				

Position 1 Model Series	Position 2 Center Section	Position 3 Connections	Position 4 Wetted Parts	Position 5 Hardware	Position 6 Seat Material	Position 7 Ball Material	Position 8 Diaphragm Material
WB15 - Standard Pump	A - Aluminum* R - Polypropylene S - Stainless Steel*	A - NPTF Thread B - BSP Thread	A - Aluminum* C - Cast Iron S - Stainless Steel*	P - Plated Steel S - Stainless Steel	A - Santoprene® C - Hytrel® E - Carbon Steel F - Aluminum G - Nitrile H - 440 Stainless Steel L - Hastelloy-C S - 316 Stainless Steel	A - Santoprene® C - Hytrel® G - Nitrile S - 316 SS T - PTFE V - Viton®	A - Santoprene® C - Hytrel® G - Buna-N L - Long-Life PTFE T - PTFE/Santoprene® V - Viton®

Hytrel® is a registered trademark of DuPont company, Santoprene® is registered trademark of Monsanto and Viton® is a registered trademark of ExxonMobil

### Accessories

- Service Repair Kits:**  
**AIR SECTION: WB637389;**  
**FLUID SECTION: WB637375-XXX( with seats);**  
**MAJOR AIR VALVE ASSEMBLY: WB637390-X;**

# 1-1/2" WB METALLIC Models

## MODEL: WB15X-XXX-XXX

### DIMENSIONS:

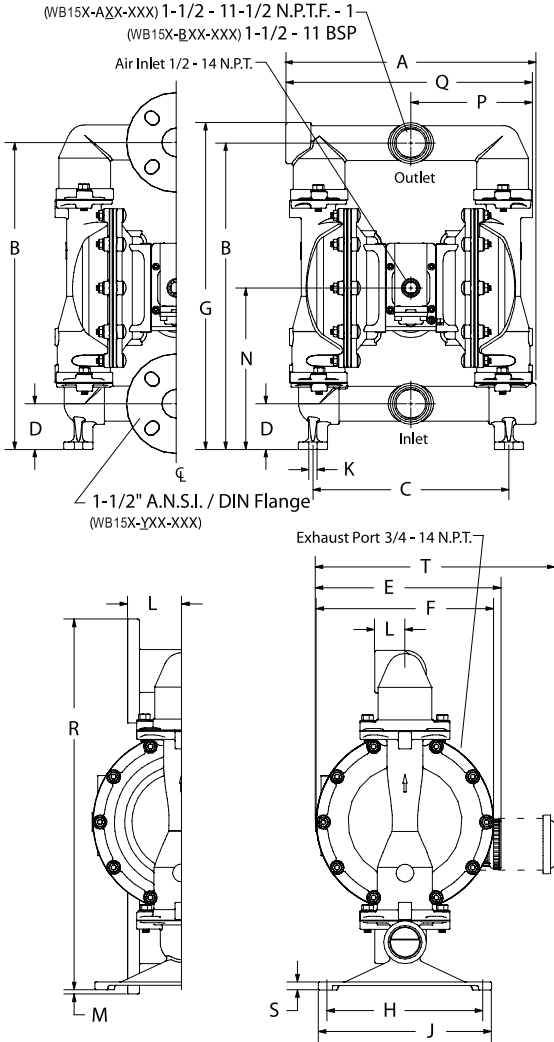

- A - see below
- B - 18-3/8" (466.7 mm)
- C - 11-3/4" (298.5 mm)
- D - 2-3/4" (69.9 mm)
- E - see below
- F - 10-1/4" (260.4 mm)
- G - 19-5/8" (498.1 mm)
- H - 9" (228.6 mm)
- J - 10" (254.0 mm)
- K - 1/2" (12.7 mm)
- L - see below
- M - 1/4" (6.4 mm)
- N - 9-11/16" (246.0 mm)
- P - see below
- Q - see below
- R - 21-7/16" (543.9 mm)
- S - see below
- T - see below

	"A"	"L"
WB15 X- <u>X</u> A-XXX	14-7/8" (377.8 mm)	1-3/4" (44.5 mm)
WB15 X- <u>X</u> C-XXX	14-5/8" (371.5 mm)	1-3/4" (44.5 mm)
WB15 X- <u>X</u> H-XXX	14-9/16" (370.0 mm)	3-1/8" (79.4 mm)
WB15 X- <u>A</u> S-XXX, - <u>B</u> S X	14-25/32" (375.5 mm)	1-3/4" (44.5 mm)
WB15 X- <u>Y</u> S-XXX	14-9/16" (370.0 mm)	3-1/8" (79.4 mm)

	"E"	"T"
WB15 <u>A</u> -XXX-XXX	-----	14-1/32" (356.2 mm)
WB15 <u>R</u> -XXX-XXX	11-3/32" (281.3 mm)	-----
WB15 <u>S</u> -XXX-XXX	-----	13-27/32" (351.4 mm)

	"P"	"Q"	"S"
7-7/32" (183.4 mm)	14-23/32" (373.9 mm)	1/2" (12.7 mm)	
7-3/16" (182.6 mm)	14-1/2" (368.3 mm)	1/4" (6.4 mm)	
7-3/16" (182.6 mm)	14-1/2" (368.3 mm)	1/4" (6.4 mm)	
7-9/32" (185.0 mm)	14-13/16" (375.5 mm)	15/32" (11.4 mm)	
7-9/32" (185.0 mm)	14-9/16" (370.0 mm)	15/32" (11.4 mm)	

	"E"	"T"
WB15 <u>A</u> -XXX-XXX	-----	14-1/32" (356.2 mm)
WB15 <u>R</u> -XXX-XXX	11-3/32" (281.3 mm)	-----
WB15 <u>S</u> -XXX-XXX	-----	13-27/32" (351.4 mm)

### PERFORMANCE CURVE:

