

## 1/2" WB METALLIC Models MODEL: WB05P-XXS-XXX

### SPECIFICATIONS:

Ratio: 1:1  
 Maximum Flow: 13 g.p.m. (49.2 l.p.m.)  
 Displacement per cycle: 0.040 Gallons (0.15 Liters)  
 Air Inlet: (Female) 1/4 - 18 PT.F. SAE Short

Fluid Inlet/Outlet: 1/2 - 14 N.P.T.F. - 1  
 Rp 1/2 (1/2 - 14 BSP, parallel)

Max. operating pressure: 100-psi (6.9-bar)  
 Suspended solids max. dia.: 3/32-in. (2.4-mm)

Weight: lbs (kg)      WB05P-XAS-XXX      8.36 (3.8)  
                                     WB05P-XSS-XXX      14.6(6.6)

Maximum dry suction lift: ft (m) 15 ( 4.5)  
 Sound Level: 70 PSI 60 Cycles/Min 71.1 db(A)



### MODEL DESCRIPTION & ORDERING:

Position	1	2		3	4	5		6	7	8	
Example:	<b>WB05</b>	<b>P</b>	-	X	X	S	-	X	X	X	-

Position 1 Model Series	Position 2 Center Section	Position 3 Connections	Position 4 Manifold Material	Position 5 Hardware	Position 6 Seat Material	Position 7 Ball Material	Position 8 Diaphragm Material
WB05	P - Polypropylene	A - 1/2 - 14 N.P.T.F. - 1 B - Rp 1/2 (1/2 - 14 BSP, parallel)	A - Aluminum S - Stainless Steel	S - Stainless Steel	F - Aluminum P - Polypropylene S - Stainless Steel 316	A - Santoprene G - Nitrile S - Stainless Steel T - PTFE V - Viton	A - Santoprene G - Nitrile T - PTFE/Santoprene V - Viton

## 1/2" WB METALLIC Models MODEL: WB05P-XXS-XXX

### DIMENSIONS:

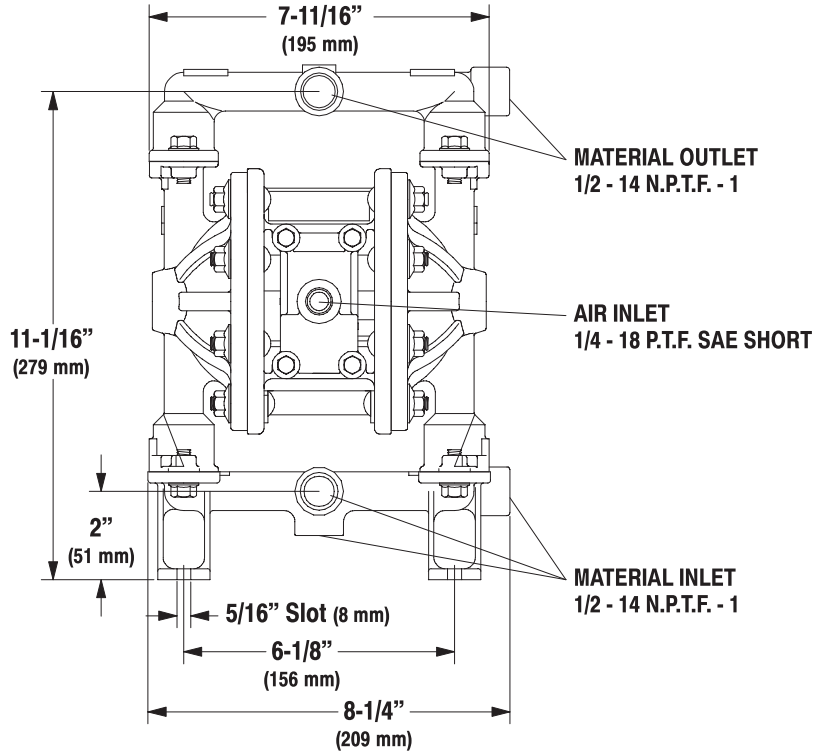
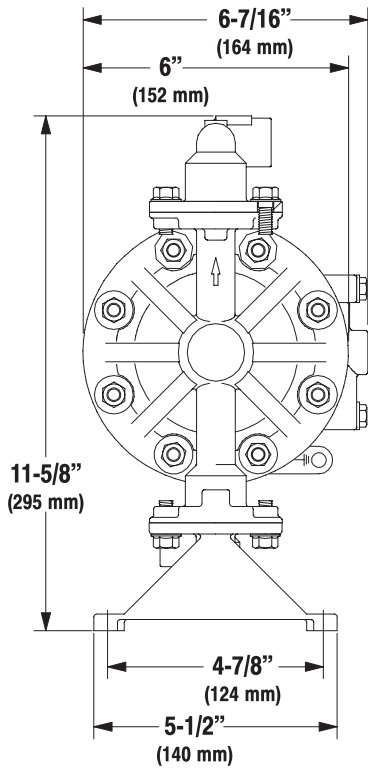

Dimensions shown are for reference only, they are shown in inches and millimeters (mm).

### PERFORMANCE CURVE:

